

TITAN 120

MARINE LED FLOOD LIGHT

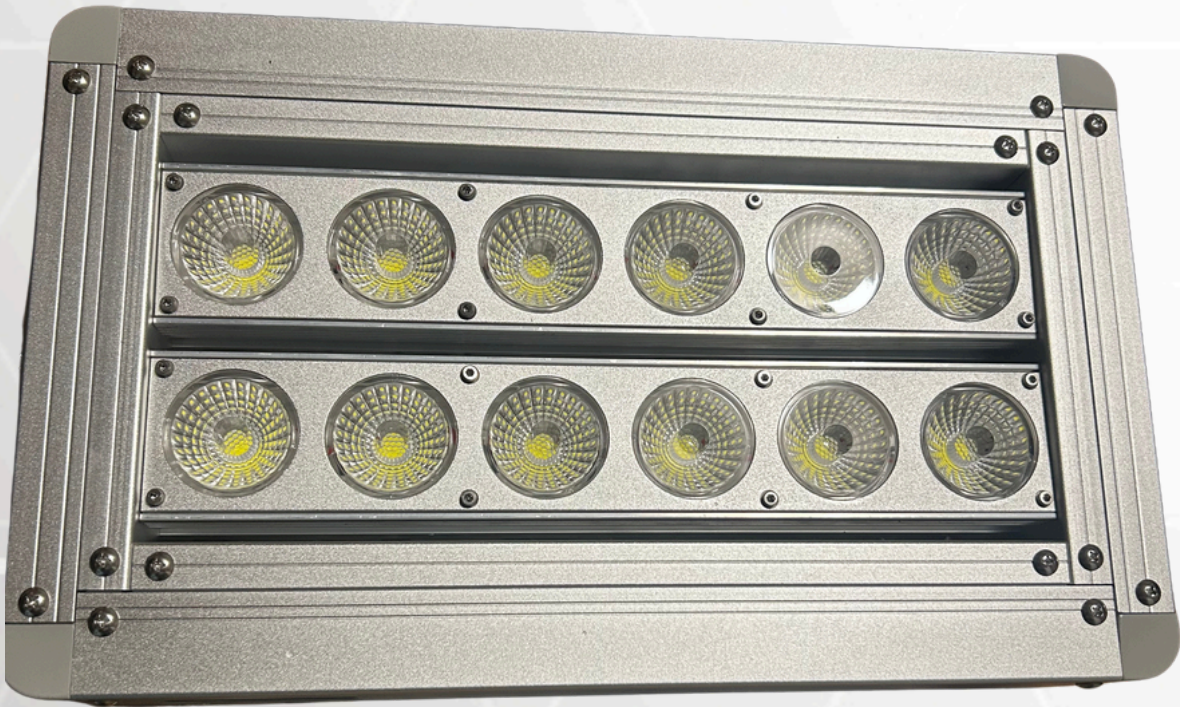

The Titan 120 brings the proven reliability and modular design philosophy of the Titan series to applications requiring compact, high-efficiency illumination. As the most versatile member of the Titan family, the 120 delivers exceptional performance in a smaller footprint, making it ideal for auxiliary lighting, working areas, and installations where space constraints demand a more compact solution without compromising the durability and serviceability that define the series.

Built on the same engineering principles that have made the Titan 540, 650, and 750 the preferred choice for demanding marine environments, the Titan 120 features robust marine-grade anodized aluminum construction, IP67 environmental protection, and the field-serviceable modular architecture that minimizes lifetime ownership costs. Despite its compact size, the Titan 120 delivers an impressive 19,200 lumens at 160 lm/W luminous efficacy, providing superior illumination while consuming minimal power.

Whether deployed as auxiliary deck lighting on commercial fishing vessels, working area illumination on offshore platforms, or supplemental lighting for maritime facilities, the Titan 120 extends the Titan series' reputation for uncompromising quality to applications where every inch of space matters. The fixture's compact dimensions and reduced weight simplify installation while maintaining the thermal management and optical performance expected from the Titan lineage.

Like all Titan series fixtures, the 120 is designed for the long term—engineered to perform reliably in salt spray, extreme temperatures, and the vibration characteristic of marine operations, with modular LED assemblies that enable cost-effective field service and upgrades throughout its 10+ year operational life.

TECHNICAL DATA

Model Number	Titan 120
Power	120W
Luminous Efficacy	160lm/W
Lumen Output	~19,200 lm
LED Chips	Bridgelux (high-power, high-lumen)
Dimensions (L x W x H)	14.8" x 9.0" x 3.5" (376 x 228 x 90 mm)
Luminaire Net Weight	Without Bracket: 12.8 lbs (5.8 kg) With Bracket: ~14.5lbs
CCT (Color Temperature)	Standard: 2700K, 4000K, 5000K – Colored options available
CRI (Color Rendering Index)	Standard >75, (>85 / >95 available options)
System Efficiency	≥93%
Beam Pattern	10°, 25°, 40°, 60°, 90°, 120°
IP Rating	IP67 / IK10
Lifespan	L80: >80,000 hours Chip lifespan: 100,000 hours
Storage Temperature	-40°C to +85°C (-40°F to +185°F)
Operating Temperature	-40°C to +60°C (-40°F to +140°F)
Certification	ETL / DLC / TUV / SAA / CE / RoHS / ErP UL1598, CSA C22.2 #250.0 IP67, IK10
Color of Housing	Silver Anodized Marine Aluminum - Copper Free
Bracket	4mm 316 S/S

ELECTRICAL DETAILS

Input Voltage	AC 90-305V (347V/480V option)
Power Frequency	50-60Hz
Power Efficiency	>93%
Power Factor	≥0.93
Total Harmonic Distortion	≤20%
Surge Protection	4KV
Driver	UL/CUL listed Meanwell power supply (HLG series)
Dimming Options	0-10V, DALI, DMX, Wi-Fi, RGB (available)

TARGET APPLICATIONS

The Titan 120 is engineered for versatile deployment in marine and industrial environments where compact, high-efficiency lighting is essential:

- Auxiliary deck and working area lighting on commercial vessels
- Small to medium fishing boats requiring efficient, space-saving illumination
- Supplemental lighting for offshore platforms and drilling operations
- Marina docks, gangways, and pedestrian areas
- Industrial facilities requiring IP67-rated flood lighting
- Replacement for 250W-400W HID/sodium fixtures in compact installations

KEY FEATURES & BENEFITS

Compact Design with Titan-Series Performance

At just 14.8" × 9.0" × 3.5" and weighing only 12.8 lbs, the Titan 120 delivers 19,200 lumens of high-quality illumination in a remarkably compact package, making it ideal for installations where larger fixtures cannot be accommodated.

Modular Serviceability

True to Titan series design philosophy, the 120 features field-replaceable LED modules that enable quick repairs and upgrades, minimizing downtime and reducing long-term maintenance costs compared to sealed fixtures.

Exceptional Efficiency

At 160 lm/W luminous efficacy with >93% system efficiency, the Titan 120 provides superior light output per watt, significantly reducing energy consumption and heat generation compared to traditional lighting technologies.

Marine-Grade Durability

IP67-rated weatherproof construction with IK10 impact resistance ensures reliable operation in harsh marine environments. Marine-grade anodized aluminum housing provides excellent corrosion resistance without copper contamination, meeting stringent maritime standards.

DIMENSIONS

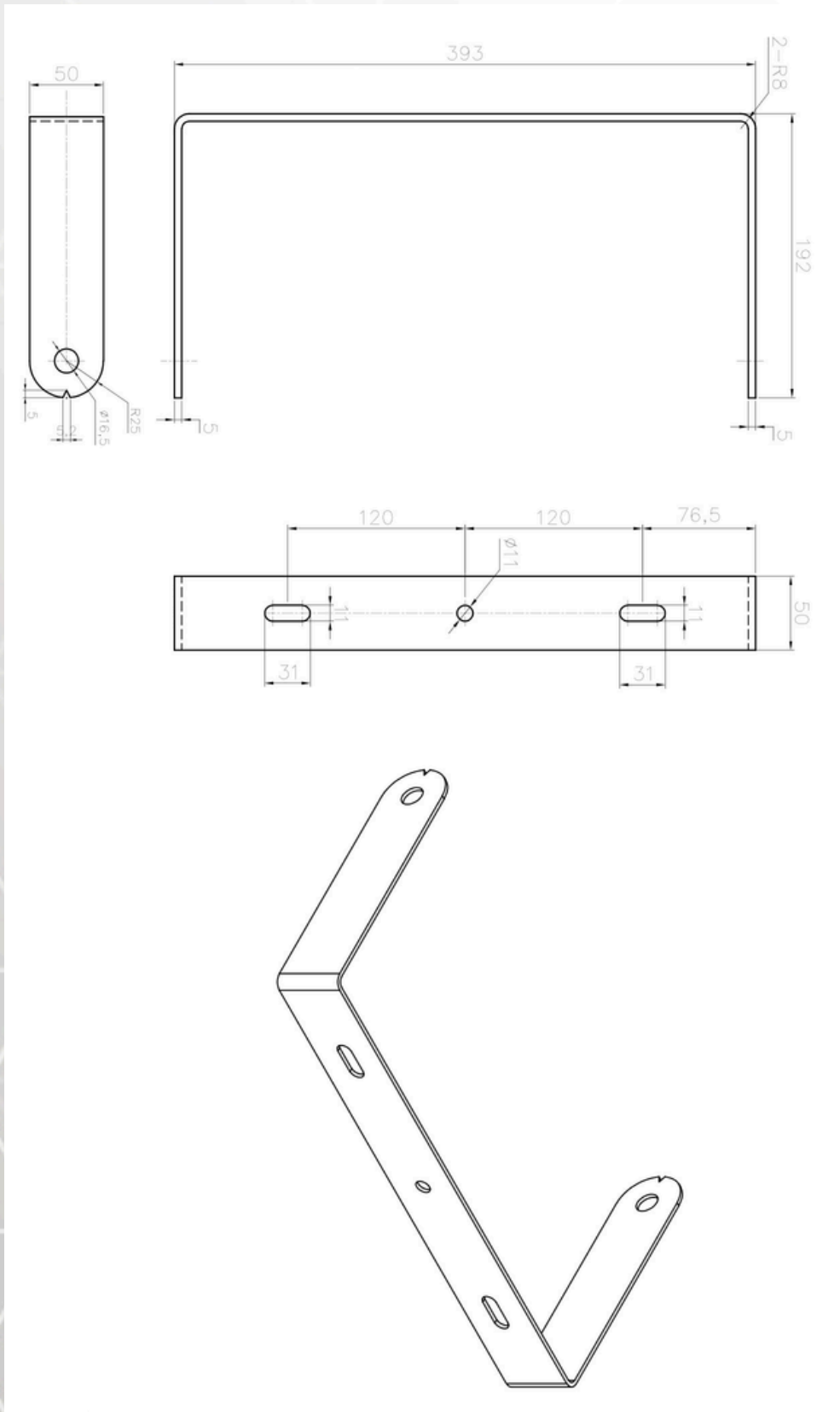

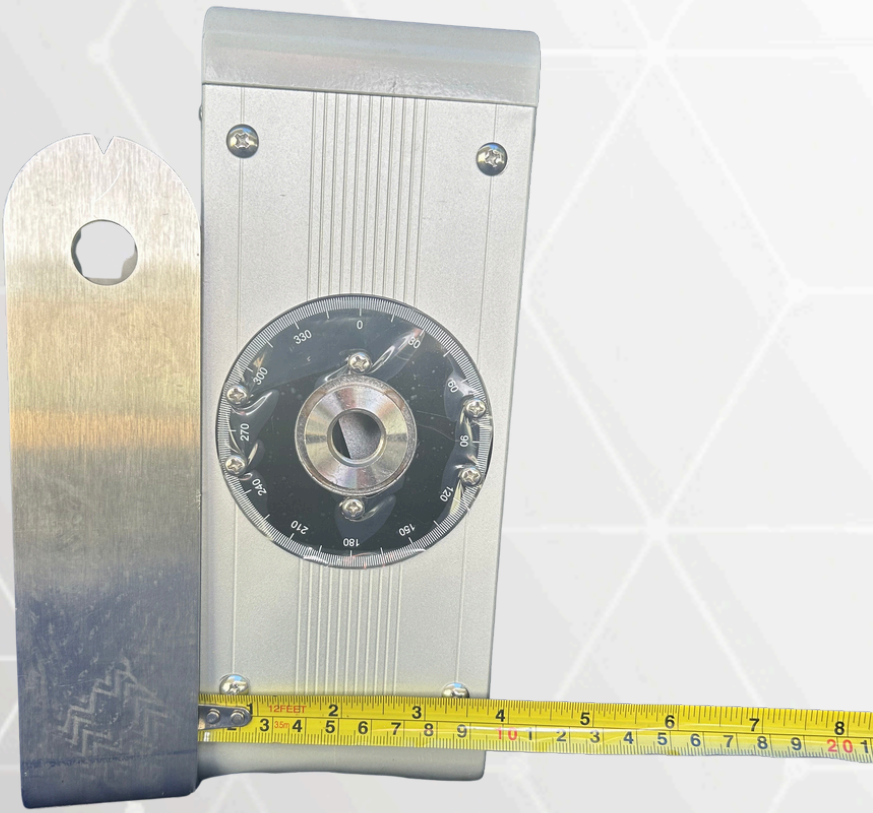

ORDERING SHEET

PRODUCT	VOLTAGE	BEAM PATTERN	COLOR (CCT)	BRACKET	APPLICATION
Titan 120	1. 110-277VAC	1. 10°	1. 2700K	1. Slip Fitter/Pole mount	1. IP68 Marine App.
		2. 25°	2. 4000K *	2. Flat Bracket	2. IP66 Industrial App.
		3. 40°	3. 5000K *		
		4. 60°			
		5. 90° *			
		6. 120° *			

* additional cost and lead time may apply